

 MITSUBISHI CHEMICAL COMPOSITES AMERICA, INC.

**ALPOLIC®**  
METAL COMPOSITE MATERIALS

Your Design | **Perfected**

CORPORATE ID BROCHURE

WE UNDERSTAND

**BRAND APPEAL**

# REVEAL

*Show the world who you are, wherever you are. You've invested in a look that's instantly recognizable, with colors and forms that convey the essence of your brand identity. Reaffirming the promise of excellence you make every time a customer encounters your business.*

*Reveal your corporate identity in precision matched colors that retain their hue, tone and gloss for years to come. Using materials that can be precisely fabricated into your brand's instantly recognizable forms. With a partner you can count on to deliver.*

*Affordable, easy to install and maintain, uniquely yours – that's the beauty of the ALPOLIC® Corporate ID Program. Your design, perfected.*



Gwinnett Place Ford, Duluth, GA  
ALPOLIC®/PE in HLZ Hairline Aluminum Finish



ALPOLIC®  
METAL COMPOSITE MATERIALS

Your Design | Perfected

# INFLUENTIAL

**ON CLADDING, FASCIA, CANOPIES, ENTRYWAYS, SIGNAGE, COLUMN COVERS AND MORE, YOUR BRAND COLORS EXERT A POWERFUL INFLUENCE. ADORNING YOUR LOGO AND ARCHITECTURE, YOUR COLORS ARE AMONG YOUR MOST DISTINCTIVE BRAND ASSETS. THE ALPOLIC® CORPORATE ID PROGRAM HELPS CELEBRATED BRANDS AROUND THE WORLD PROCLAIM AND PROTECT THEIR UNIQUE IDENTITY IN EVERY SETTING. LET'S BUILD AN INDELIBLE IMPRESSION FOR YOUR BRAND.**



Exxon Mobil, VA, United States, ALPOLIC®/PE in PMB Blue/SAW White, FEF Red/SAW White, and ETT Tan Multi-Color and Solid Finishes

### **The Consistent Colors You Demand – On Demand**

We stock an incredible range of finishes and colors, and provide custom color-matching to realize virtually any architectural vision. When you join our Corporate ID Program, you gain immediate access to the finest architectural materials available, in the exact colors you specify, ready for delivery wherever in the world you do business.

When you're ready to build, we're ready with the finishes and glosses you need to build a consistent brand identity across every location.

### **The Right Materials for the Job**

Affordable ALPOLIC® materials deliver superior flatness, vibration damping, durability and ease of maintenance. These lightweight aluminum composite materials offer the rigidity of heavy-duty sheet metal, with much simpler fabrication using ordinary woodworking or metalworking tools. So you can easily create complex forms with crisp bends, seams and edges that speak for the quality of your brand.

Choose ALPOLIC® materials with our classic PE polyethylene core or our fire-retardant fr core, meeting many fire codes worldwide. Both feature aluminum skins finished in your brand colors, and we also offer a variety of decorative, multi-color and natural metal finishes to beautifully complement your corporate identity.

### **A New Generation of Finish Quality and Durability**

We render your brand identity in Lumiflon® FEVE, a remarkable fluoropolymer resin finish we're proud to have introduced to our industry in North America.

No building material finish offers a wider range of brilliant colors and glosses. And its unique chemical structure makes Lumiflon® FEVE significantly more resistant to impacts, abrasions, weather and chemicals. It's practically maintenance-free, and can even be field-painted if the need should ever arise.

Lumiflon® FEVE finishes are warranted for up to 30 years against cracking, chalking and changes in color or gloss. So you can expect your brand to look as great decades from now as it does today.



# UNIVERSAL

**WHATEVER YOUR INDUSTRY, WHATEVER YOUR BRAND, WE'RE THE ONE ARCHITECTURAL PANEL SUPPLIER YOU NEED FOR CANOPIES, FAÇADES, ENTRYWAYS, AND INTERIOR SPACES THAT PERFECTLY EXPRESS YOUR IDENTITY.**

## **FOOD SERVICE**

Build franchises quickly and consistently, with easy fabrication and installation. Keep your corporate colors looking great through years of exposure to the demanding food service business.

## **ENTERTAINMENT**

Count on the brilliant colors and glosses that bring your brand of fun to life. Get a consistent look across complex design elements, from your marquee to entryways, column covers, fascia, signage and more.

## **BANKING**

Bring the focus of attention to your branches in this competitive industry. Make your mark with easily fabricated materials that express the quality and dependability of the services you provide.

## **AUTOMOTIVE**

Show off your brand with the same attention to detail that you lavish on your vehicles. Create eye-catching façades and signage that draw people into your business and an elegant showroom that keeps them there.

## **PETROLEUM**

Motorists have dozens of stations to choose from. Make sure they choose yours with bold signage and multi-colored canopies that grab attention while speaking for the quality of your products and services.

## **HOSPITALITY**

Welcome your guests with clean, sophisticated designs in your elegant brand colors. Lightweight, easy-to-fabricate ALPOLIC® materials help you meet your budget – while meeting fire and safety codes virtually anywhere.

## **RETAIL**

Master the time, cost and quality demands of the ever-changing retail environment. Build customer affinity with eye-catching materials that stay true to your brand under the most demanding conditions.



GRAPHIC-AL® LT Interior Display



Crocs, New York, NY, ALPOLIC®/fr in Yellow, Black and Custom Crocs Green Solid Color Finish

Wow! That's Fresh, Brandon, FL ALPOLIC®/PE in custom FMG Green, RON Red and ALPOLIC®/fr in Walnut Timber Finish



# GRAPHICAL

FOR SIGNAGE AND DISPLAY

**WITH THINNER SKINS THAN STANDARD ALPOLIC® ALUMINUM COMPOSITE MATERIALS, GRAPHIC-AL® PANELS ARE IDEAL FOR BUSINESS SIGNS, WAYFINDING, DISPLAYS AND CANOPIES.**

**GRAPHIC-AL® LT** is a lightweight yet durable aluminum composite panel that can be easily worked with ordinary cutters, routers and benders, but can withstand external loading once installed. These reversible panels are coil-coated with polyester paints and are compatible with graphic films and screen printing.

**GRAPHIC-AL® HP** is coil-coated with paint that is suitable for outdoor canopies and fascia signs for corporate identity and retail shops.

**GRAPHIC-AL® DP** is a super-lightweight panel that can be direct-printed for signage and displays. Rigid, flat and smooth, it's easy to fabricate and is compatible with flatbed printers and UV-curable inks.

# IDEAL

ALPOLIC® materials are ideal for architectural brand identity projects because they're lighter in weight, easier to fabricate into complex forms, and easier to install than traditional materials. Yet they offer superior flatness, durability, stability, vibration damping and ease of maintenance.

With precision matched colors and glosses in an incredibly tough and stable Lumiflon® FEVE finish, your brand identity is a reliable mark of distinction for years to come. ALPOLIC® products and finishes are backed by up to a 30-year warranty.

## **Product Properties**

ALPOLIC® aluminum composite materials (ACM) are produced by continuously bonding two thin sheets of aluminum on either side of an extruded thermoplastic or mineral-filled, fire-retardant thermoplastic core. The aluminum surfaces have been pre-finished and coil-coated in a variety of paint finishes before bonding.

We also offer metal composite materials (MCM) featuring skins of copper, zinc, stainless steel or titanium bonded to the same cores and left unfinished. ALPOLIC® ACM and MCM both offer the rigidity of heavy-gauge sheet metal in a lightweight composite material.

## **Ease of Fabrication**

ALPOLIC® ACM can be fabricated with ordinary woodworking or metalworking tools, with no special tools required. Cutting, grooving, punching, drilling, bending, rolling and many other specialized fabrication techniques can be easily performed to create a virtually unlimited variety of complex forms and shapes.



### **MANUFACTURING FLEXIBILITY**

ALPOLIC® materials are offered in a variety of thicknesses: 2mm, 3mm, 4mm and 6mm

### **STANDARD WIDTHS**

40"    48"    50"    62"

### **SEMI-STANDARD WIDTHS**

Consult Customer Service

### **CUSTOM WIDTHS**

Consult Customer Service

### **RANGE OF SIZES**

Width: 40"– 62" (826mm – 1,575mm)

Length: 6'– 24' (1,829mm – 7,315mm)

### **PRODUCT TOLERANCE**

ALPOLIC® materials are trimmed and squared with cut edges to offer the best panel edge conditions in the industry.

Width:  $\pm 0.08"$  (2mm)

Length:  $\pm 0.16"$  (4mm)

### **PRODUCT TOLERANCE**

3mm  $\pm 0.008"$  (0.2mm)

4mm  $\pm 0.008"$  (0.2mm)

6mm  $\pm 0.012"$  (0.3mm)

### **BOW MAXIMUM**

0.5% of length and/or width

### **SQUARENESS MAXIMUM**

0.2" (5mm)



# FUNCTIONAL

ALPOLIC® MATERIALS ARE UNSURPASSED IN THEIR FUNCTIONAL ADAPTABILITY, FREEING ARCHITECTS AND FABRICATORS TO COLLABORATE ON INNOVATIVE DESIGN FORMS AND CLADDING SYSTEMS. IN CITIES AROUND THE WORLD, YOU'LL FIND BUILDINGS THAT REVEAL STRIKING NEW POSSIBILITIES, ACHIEVED THROUGH THE TEAMWORK OF VISIONARY ARCHITECTS AND SKILLED FABRICATORS WORKING WITH VERSATILE ALPOLIC® MATERIALS.

## ROUT AND RETURN WET SEAL

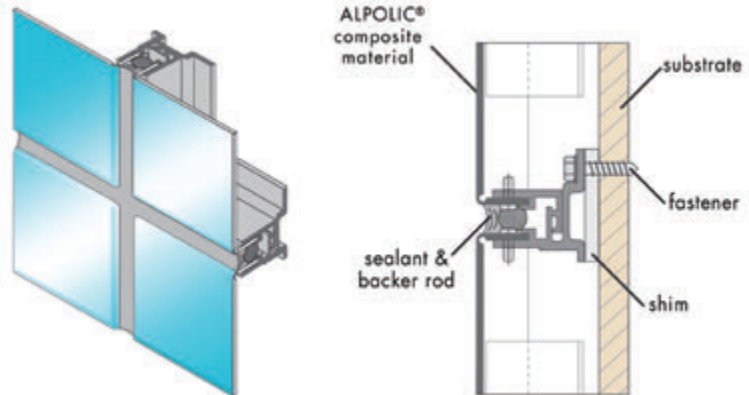

## RAINSCREEN

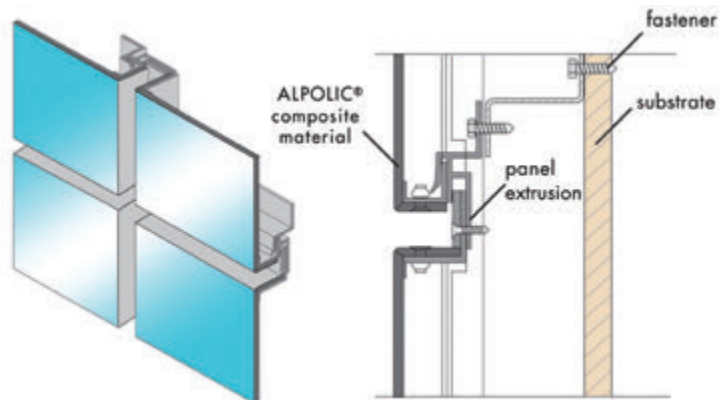

### ROUT & RETURN DRY GASKET SEAL

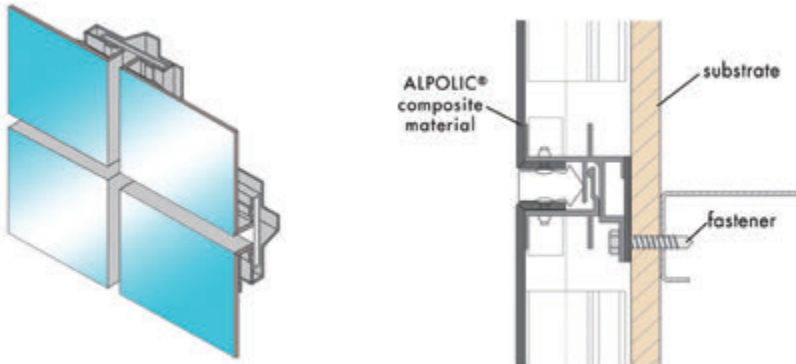

### INTERIOR ROLLED PIN EDGE

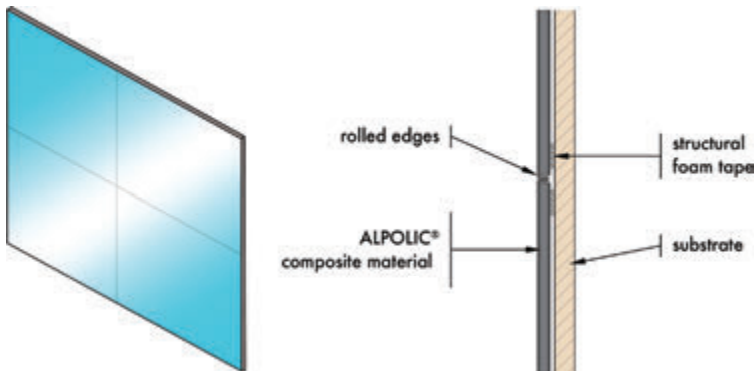

# EFFECTUAL

Let us know how we can help you make your design idea a reality. Get more information, order finish samples and find a fabricator by calling 1-800-422-7270 or visiting [alpolic-americas.com](http://alpolic-americas.com).

